

Series 10-MS

Stainless Miniature Fittings

RoHS

Construction



Hose nipple

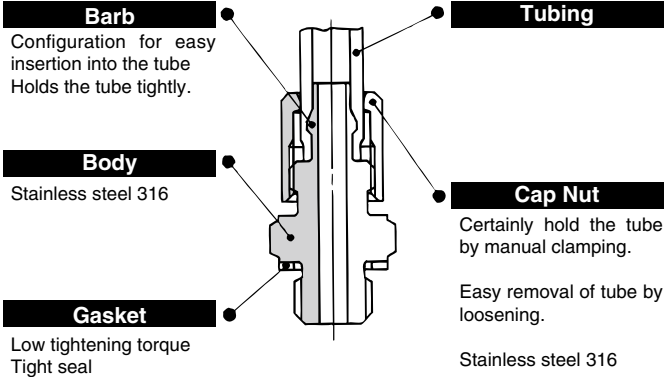

Barb fitting

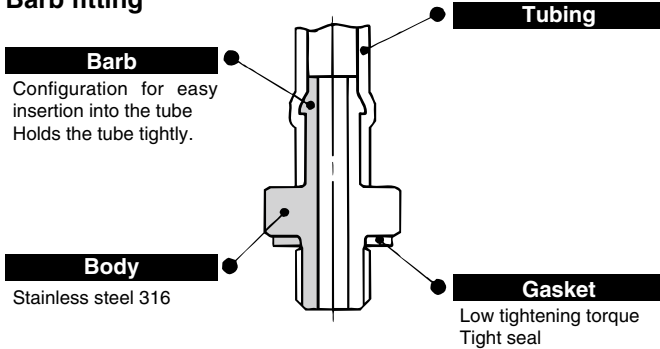

Specifications















Applicable tubing material	Polyurethane	
Applicable tubing diameter	ø3.18/ø2, ø4/ø2.5, ø6/ø4	
Fluid	Air, N ₂ , Water (Note 1, 2, 3)	
Max. operating pressure (at 20°C)	0.8 MPa	
Ambient and fluid temperature	-5 to 60°C, Water: 0 to 40°C (No freezing)	
Connection size	M5	
Material	Body	Stainless steel 316
	Gasket	PVC, Nylon 66, GF30%
Grease	Fluorine grease (10-MS-5UN only)	
Cleanliness class (ISO class)	Class 3	

Note 1) Barb fitting, barb elbow and barb tee are not compatible with water.

Note 2) Deionized water is not recommended for use as it may affect the material used in the fittings. In addition, it is known to degrade the water quality.

Note 3) As the universal nipple comes with grease, it cannot be used when N₂ is used as clean, dry air.

Model

Model	Description	Application	Note	Model	Description	Application	Note	
10-MS-5AU-3	Barb fittings for polyurethane tube	For polyurethane tube	ø3.18/ø2 x M5	10-MS-5UL	Universal elbow	Body rotates at 360° around the stud axis.	M5 female x M5 male	
10-MS-5AU-4			ø4/ø2.5 x M5					
10-MS-5AU-6			ø6/ø4 x M5					
10-MS-5ALHU-3	Barb elbow for polyurethane tube	For polyurethane tube Body rotates at 360° around the stud axis.	ø3.18/ø2 x M5	10-MS-5B	Bushing	For reducing R (PT) 1/8 to M5	R1/8 x M5 female	
10-MS-5ALHU-4			ø4/ø2.5 x M5					
10-MS-5ALHU-6			ø6/ø4 x M5		10-MS-5P			Plug
10-MS-5H-4	Hose nipple	For polyurethane tube	ø4/ø2.5 x M5					
10-MS-5H-6			ø6/ø4 x M5	10-MS-5J		Extension fitting	Solid piece moves fitting up from workpiece.	M5 male x M5 female
10-MS-5HLH-4	Hose elbow	For polyurethane tube Body rotates at 360° around the stud axis.	ø4/ø2.5 x M5					
10-MS-5HLH-6			ø6/ø4 x M5		10-MS-5N	Nipple		
10-M-5G1	Gasket	To seal M5 thread	Material: PVC					
10-MS-5ATHU-3	Barb tee for polyurethane tube	For polyurethane tube Body rotates at 360° around the stud axis.	ø3.18/ø2 x M5	10-MS-5UN		Universal nipple	Body rotates at 360° around the stud axis.	M5 male x M5 male PAT.
					10-MS-5ATHU-4			
					10-MS-5ATHU-6			
10-M-5GH	Gasket (H)	To seal M5 thread	Material: Nylon 66, GF30% only					

Directional Control Valves

Air Cylinders

Rotary Actuators

Air Grippers

Air Preparation Equipment

Modular F. R.

Pressure Control Equipment

Fittings & Tubing

Flow Control Equipment

Pressure Switches/ Pressure Sensors

Barb Fittings for Polyurethane Tube: 10-MS-5AU-3, -4, -6

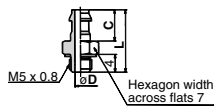

Model	C	D	L	Effective area (mm ²)	Weight (g)
10-MS-5AU-3	4.5	1.6	11.5	1.7	1.4
10-MS-5AU-4	5	1.8	12	2.1	1.5
10-MS-5AU-6	7	2.5	14	4.0	1.7

Barb Elbow for Polyurethane Tube: 10-MS-5ALHU-3, -4, -6

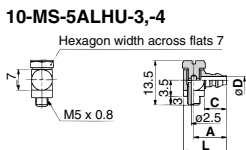

Model	A	C	D	L	Effective area (mm ²)	Weight (g)
10-MS-5ALHU-3	8	4.5	1.6	11.8	1.1	3.0
10-MS-5ALHU-4	8.8	5.0	1.8	12.6	1.4	3.1
10-MS-5ALHU-6	10.8	7.0	2.5	14.6	2.4	3.7

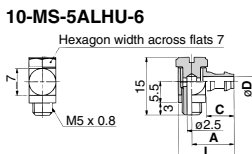

Hose Nipple: 10-MS-5H-4, -6

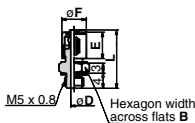

Model	B	D	L	E	F	Effective area (mm ²)	Weight (g)
10-MS-5H-4	7	1.8	15.5	7	6.5	2.1	2.5
10-MS-5H-6	8	2.5	16.5	8	8.5	4.0	3.7

Hose Elbow: 10-MS-5HLH-4, -6

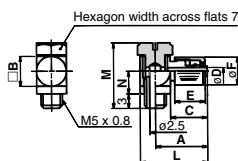

Model	A	B	C	D	E	F	L	M	N	Effective area (mm ²)	Weight (g)
10-MS-5HLH-4	12	7	8.5	1.8	7	6.5	15.8	15	5.5	1.4	4.2
10-MS-5HLH-6	13.5	8	9.5	2.5	8	8.5	17.8	16	6	2.4	6.2

Universal Elbow: 10-MS-5UL

Effective area: 2.4 mm²
Weight: 4.5 g

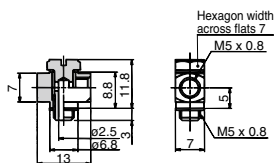

Universal Tee: 10-MS-5UT

Effective area: 2.4 mm²
Weight: 4.5 g

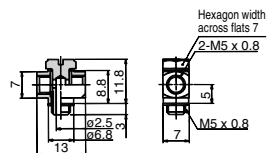

Bushing: 10-MS-5B

Effective area: 12 mm²
Weight: 5.5 g

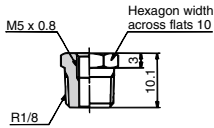

Plug: 10-MS-5P

Weight: 1.2 g

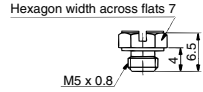

Extension Fitting: 10-MS-5J

Effective area: 4.0 mm²
Weight: 3.4 g

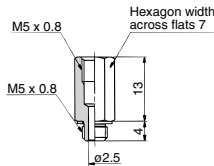

Nipple: 10-MS-5N

Effective area: 4.0 mm²
Weight: 1.4 g

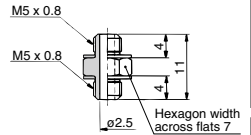

Barb Tee for Polyurethane Tube: 10-MS-5ATHU-3, -4, -6

10-MS-5ATHU-3, -4

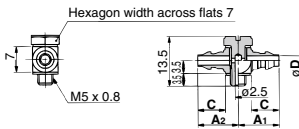

10-MS-5ATHU-6

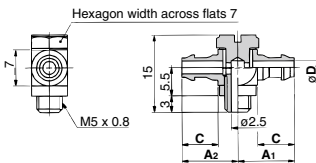

Model	A1	A2	C	D	Effective area (mm ²)	Weight (g)
10-MS-5ATHU-3	8	8.3	4.5	1.6	1.1	3.4
10-MS-5ATHU-4	8.8	8.8	5.0	1.8	1.4	3.6
10-MS-5ATHU-6	10.8	10.8	7.0	2.5	2.4	4.2

Universal Nipple: 10-MS-5UN

Effective area: 4.0 mm²
Weight: 3.7 g

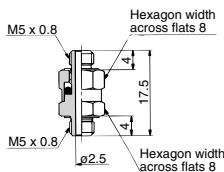

Gasket: 10-M-5G1, 10-M-5GH

Weight: 0.01 g

Weight: 0.04 g



Directional Control Valves
Air Cylinders
Rotary Actuators
Air Grippers
Air Preparation Equipment
Modular F. R.
Pressure Control Equipment
Fittings & Tubing
Flow Control Equipment
Pressure Switches/ Pressure Sensors